

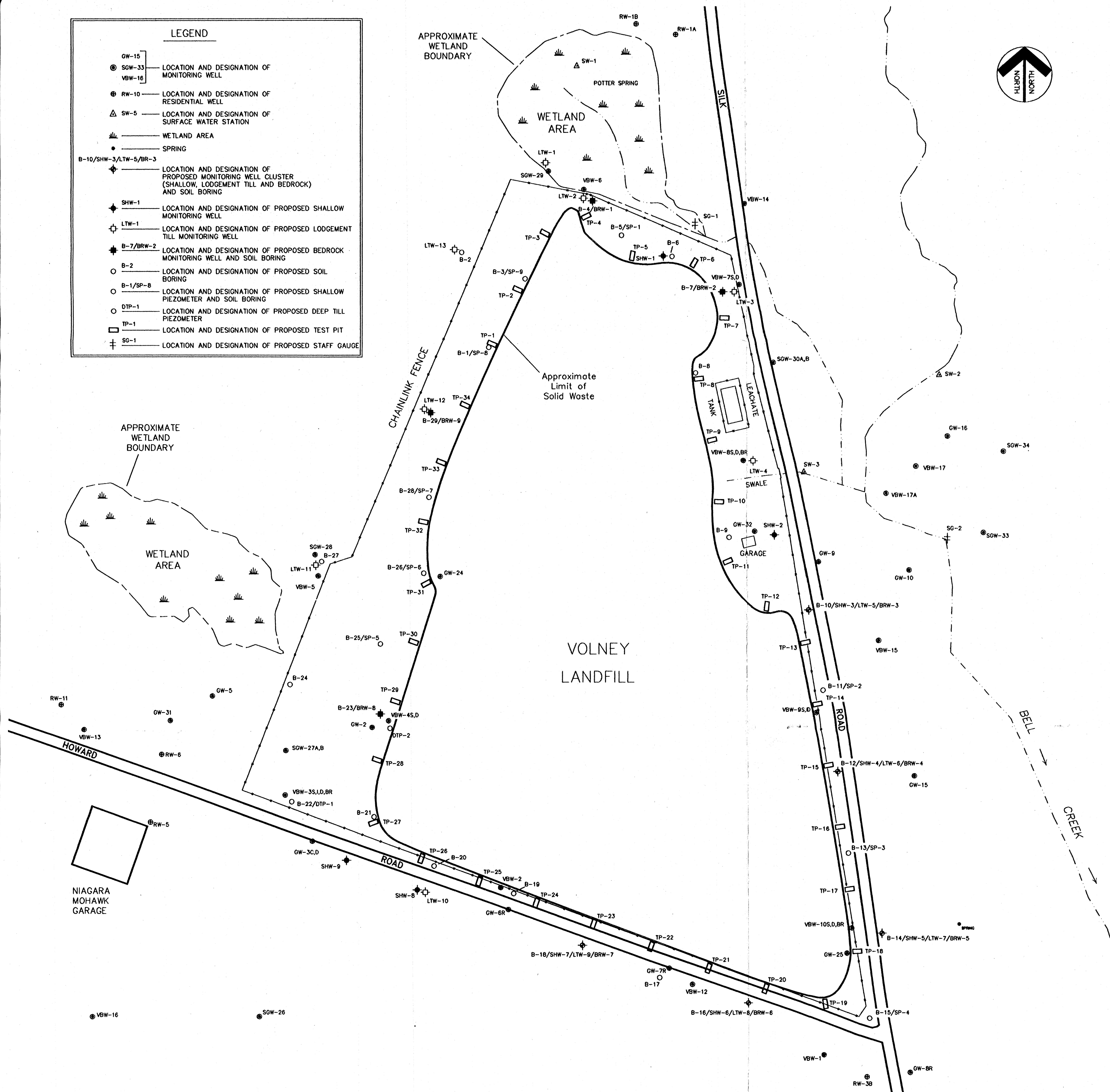

LEGEND

- GW-15
- SGW-33
- VBW-16
- LOCATION AND DESIGNATION OF MONITORING WELL
- RW-10
- LOCATION AND DESIGNATION OF RESIDENTIAL WELL
- SW-5
- LOCATION AND DESIGNATION OF SURFACE WATER STATION
- WETLAND AREA
- SPRING
- B-10/SHW-3/LTW-5/BR-3
- LOCATION AND DESIGNATION OF PROPOSED MONITORING WELL CLUSTER (SHALLOW, LODGEMENT TILL AND BEDROCK) AND SOIL BORING
- SHW-1
- LOCATION AND DESIGNATION OF PROPOSED SHALLOW MONITORING WELL
- LTW-1
- LOCATION AND DESIGNATION OF PROPOSED LODGEMENT TILL MONITORING WELL
- B-7/BRW-2
- LOCATION AND DESIGNATION OF PROPOSED BEDROCK MONITORING WELL AND SOIL BORING
- B-2
- LOCATION AND DESIGNATION OF PROPOSED SOIL BORING
- B-1/SP-8
- LOCATION AND DESIGNATION OF PROPOSED SHALLOW PIEZOMETER AND SOIL BORING
- DTP-1
- LOCATION AND DESIGNATION OF PROPOSED DEEP TILL PIEZOMETER
- TP-1
- LOCATION AND DESIGNATION OF PROPOSED TEST PIT
- SG-1
- LOCATION AND DESIGNATION OF PROPOSED STAFF GAUGE



LOCATION OF PROPOSED GROUND-WATER MONITORING WELLS, PIEZOMETERS, SOIL BORINGS AND TEST PITS, VOLNEY LANDFILL, SILK ROAD, VOLNEY, NEW YORK